

干式旋片真空压力复合气泵, 无油运行, 空气冷却  
 Rotary vane pressure/vacuum pumps, oil-free working, air-cooled

ZYBW60E  
 ZYBW80E  
 ZYBW100E  
 ZYBW140E

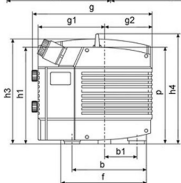
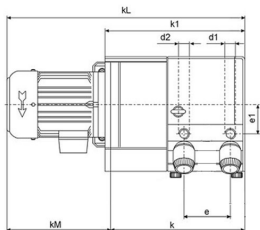

压力调节阀 / Vacuum regulating valve

真空 I 调节阀 / Vacuum regulating valve

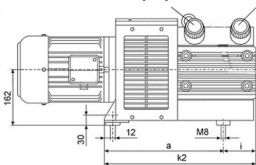

技术参数 / Table

型号 Type	流量 Delivery rate [m <sup>3</sup> /h]		电机功率需求 Motor capacity necessary [kw]				电机安装功率 Motor capacity installed [kw]			转速 Speed [RPM]		噪声 Noise level [dB(A)]		重量 Weight [kg]
	50 Hz	60 Hz	±0.5 bar		±0.6 bar		50Hz	60Hz	50 Hz	60 Hz	50 Hz	60 Hz		
ZYBW60E	58	69	2.2	2.9	2.4	3.1	2.4	3.0	1420	1700	74 / 75	75 / 76	71	
ZYBW80E	70	82	2.9	3.8	3.1	3.9	4.0	4.8	1420	1700	76 / 76	76 / 77	72	
ZYBW100E	103	120	4.0	5.2	4.4	5.4	5.5	6.4	1420	1700	76 / 77	77 / 78	129	
ZYBW140E	137	160	5.8	7.8	6.1	7.6	7.8	9.3	1420	1700	77 / 78	78 / 79	140	
电压/Voltage	2.4 - 4.8 kW : 195-255 / 330-440 V ±5% 50 Hz + 190-290 / 330-500 V ±5% 60 Hz										电机型号/Motor type		B5 / 250	
	5.5 - 9.3 kW : 340-430 / 588-745 V ±5% 50 Hz + 340-500 / 590-865 V ±5% 60 Hz													
	a	b	b1	d1	d2	d3	e	e1	e2	f	g	g1		
ZYBW60E	326	190	95.0	G 1	G 1	G 3/4	138	85	115	250	353	195		
ZYBW80E	326	190	95.0	G 1	G 1	G 3/4	138	85	115	250	353	195		
ZYBW100E	398	245	122.5	G 1 1/2	G 1 1/2	G 1 1/4	190	95	155	295	470	223		
ZYBW140E	398	245	122.5	G 1 1/2	G 1 1/2	G 1 1/4	190	95	155	295	470	223		
	g2	h1	h3	h4	i	k	k1	k2	kM	kL	o	p		
ZYBW60E	141	289	312	328	96	397	415	448	≤ 313	≤ 710	46	289		
ZYBW80E	141	289	312	328	96	397	415	448	≤ 371	≤ 768	46	289		
ZYBW100E	230	297	330	336	140	521	539	563	≤ 374	≤ 895	60	296		
ZYBW140E	230	297	330	336	140	521	539	563	≤ 417	≤ 938	60	296		

测试环境条件/Reference:Atmosphere 1000 mbar; 20°C	ZYBW 60E								ZYBW 80E									
	压力 pressure	50 Hz 真空/Vacuum [bar]				60 Hz 真空/Vacuum [bar]				压力 pressure	50 Hz 真空/Vacuum [bar]				60 Hz 真空/Vacuum [bar]			
		0	-0.4	-0.5	-0.6	0	-0.4	-0.5	-0.6		0	-0.4	-0.5	-0.6	0	-0.4	-0.5	-0.6
吸气流量/Suction air rate [m³/h]	+ 0.4	96.0	29.2	21.8	16.7	65.2	35.3	28.1	21.6	+ 0.4	64.0	32.5	25.0	18.0	77.7	40.7	31.9	23.8
排气流量/Blast air rate [m³/h]		58.0	42.7	37.5	33.9	68.6	48.9	44.7	38.3		66.0	51.9	47.5	43.1	82.7	63.0	56.8	50.9
功率吸收/Power absorbed [kW]		1.79	2.08	2.15	2.18	2.43	2.73	2.79	2.82		2.12	2.58	2.65	2.72	2.92	3.33	3.36	3.38
排气温度/Temp compressed air [°C]		39.0	43.0	44.0	45.0	42.0	45.0	45.0	45.0		41.0	45.0	46.0	47.0	44.0	48.0	49.0	49.0
吸气流量/Suction air rate [m³/h]	+ 0.5	55.2	28.5	22.2	16.2	65.0	34.9	27.0	21.0	+ 0.5	63.9	32.2	25.0	18.1	76.5	40.6	31.9	23.4
排气流量/Blast air rate [m³/h]		56.9	42.0	37.4	32.9	68.3	48.8	43.5	38.7		65.0	51.4	47.1	43.0	81.4	62.9	56.8	50.6
功率吸收/Power absorbed [kW]		1.89	2.21	2.25	2.31	2.53	2.85	2.85	2.92		2.18	2.65	2.74	2.80	2.93	3.38	3.44	3.46
排气温度/Temp compressed air [°C]		40.0	43.0	44.0	45.0	43.0	45.0	45.0	46.0		41.0	47.0	47.0	48.0	44.0	49.0	51.0	50.0
吸气流量/Suction air rate [m³/h]	+ 0.6	54.6	28.3	21.9	15.7	63.8	33.9	27.2	20.6	+ 0.6	63.0	32.0	24.7	17.5	76.0	40.6	31.6	23.5
排气流量/Blast air rate [m³/h]		56.2	41.4	37.0	32.4	67.1	48.3	43.3	38.1		64.8	51.1	46.8	42.3	80.6	62.5	56.0	50.2
功率吸收/Power absorbed [kW]		1.92	2.28	2.34	2.40	2.60	2.92	3.01	3.04		2.26	2.75	2.82	2.91	3.01	3.48	3.52	3.57
排气温度/Temp compressed air [°C]		40.0	44.0	45.0	45.0	44.0	47.0	47.0	48.0		43.0	46.0	46.0	48.0	46.0	51.0	51.0	51.0
测试环境条件/Reference:Atmosphere 1000 mbar; 20°C	ZYBW 100E								ZYBW 140E									
	压力 pressure	50 Hz 真空/Vacuum [bar]				60 Hz 真空/Vacuum [bar]				压力 pressure	50 Hz 真空/Vacuum [bar]				60 Hz 真空/Vacuum [bar]			
		0	-0.4	-0.5	-0.6	0	-0.4	-0.5	-0.6		0	-0.4	-0.5	-0.6	0	-0.4	-0.5	-0.6
吸气流量/Suction air rate [m³/h]	+ 0.4	95.7	51.0	40.5	29.8	112.6	62.1	49.9	37.7	+ 0.4	126.5	72.0	58.0	43.0	150	84.0	67.0	51.0
排气流量/Blast air rate [m³/h]		98.2	74.6	67.1	58.7	117.6	87.6	77.9	67.7		140	103	88.0	82.0	164	118	95	82.0
功率吸收/Power absorbed [kW]		3.16	3.88	3.99	4.10	4.44	5.00	5.04	5.11		5.00	5.30	5.35	5.35	6.60	6.50	6.30	6.30
排气温度/Temp compressed air [°C]		38.0	42.0	42.0	43.0	41.0	45.0	45.0	45.0		45.0	55.0	56.0	56.0	52.0	58.0	59.0	60.0
吸气流量/Suction air rate [m³/h]	+ 0.5	95.6	51.0	40.2	29.7	113.7	62.6	50.0	37.6	+ 0.5	126	69.0	55.0	41.0	149	83.0	66.5	50.0
排气流量/Blast air rate [m³/h]		98.0	74.7	66.9	58.8	119.0	88.3	78.2	67.8		138	101	91.0	86.0	163	117	94	81.0
功率吸收/Power absorbed [kW]		3.28	4.01	4.11	4.22	4.51	5.14	5.20	5.28		5.10	5.40	5.45	5.45	6.75	6.60	6.55	6.56
排气温度/Temp compressed air [°C]		39.0	43.0	44.0	44.0	43.0	46.0	46.0	46.0		47.0	55.0	56.0	56.0	53.0	59.0	60.0	61.0
吸气流量/Suction air rate [m³/h]	+ 0.6	96.1	50.2	39.9	29.9	112.7	61.9	49.3	37.6	+ 0.6	126	65.0	51.0	38.0	148	83.0	66.0	50.0
排气流量/Blast air rate [m³/h]		98.5	73.7	66.6	58.8	117.8	87.7	77.7	67.9		138	99.0	89.0	78.0	162	116	93	80.0
功率吸收/Power absorbed [kW]		3.43	4.17	4.27	4.37	4.66	5.29	5.37	5.44		5.25	5.55	5.55	5.60	6.85	6.75	6.80	6.85
排气温度/Temp compressed air [°C]		40.0	44.0	45.0	45.0	43.0	46.0	46.0	46.0		49.0	56.0	56.0	57.0	54.0	59.0	60.0	61.0